



THE ADVANTAGE IN PUNCHING - PUNCHING TOOLS AND SETS

Greenlee punching tools are quick. No matter whether for straight punchings in steel (St37) and stainless steel or confined areas with swivelling head: Greenlee equips you with the right set for every situation. Combined with the Speed Punch, the quickest and most-efficient punching system in our range puts you in pole position. Take the lead in punching!

**NEXT
GENERATION**



In brief

- ▶ Always ready for use due to short battery-charging times
- ▶ Heads rotatable through 360° for optimised work ergonomics
- ▶ No fatigue due to low weight
- ▶ 3x quicker punching with the Speed Punch system

► The fast one: LS 50 FLEX

The LS 50 FLEX is not just fast. It is integrally designed and produced. It is fully re-charged and ready for use in just 22 minutes. Ergonomic design and a balanced centre of gravity support you when working over long periods of time. The head rotates through 360° and reliably punches in confined areas. Combine the LS 50 FLEX with the Speed Punch system for even faster operations. There's no faster punching than this.

- Can be used for steel (St37) and stainless steel
- Ergonomic design for effortless operations
- Automatic final switch-off for even longer service life of the hole punch
- 22 min. to recharge the battery
- Integrated LED illuminates the work position
- Head rotates through 360°
- Can be combined with Speed Punch punch system for maximum punch speed



► Speed Punch set

Punching is up to three times quicker with the Speed Punch. The threadless stamp profile can be quickly replaced via a clamp technology - no more screwing the counter nut on and off. The set contains everything you need for the Speed Punch.

- Speed Punch set ISO 16 - 63, including accessories for hydraulic activation
- For all standard steel sheet
- High-quality plastic transport case for optimum product protection

► Slug Buster® set ISO 16 - 40

The Slug Buster from Greenlee separates the punch remnants automatically so that they fall from the die by themselves. No jamming or time-consuming removal of the punch remnants. The set comprises all components of the punching system.

- Slug Buster system including accessories
- Including ratchet wrench for manual activation
- Pilot drill included
- High-quality plastic transport case for optimum product protection



KWSET, Keyway punch for hydraulic use



Characteristics

- Compatible with all Greenlee hand-operated and battery powered hydraulic punches
- Simple handling

suitable for

- Mild steel (St37) to 2.5 mm thickness
- Stainless steel to 2.5 mm thickness
- 19mm, 3/4" threaded draw stud

Additional information

- When using the Quick Draw Series or LS50Flex, short spacer (part no. 50032488) is required

Item	Part No.	
KWSET	52086978	
Accessory	Part No.	Page
Spare Punch Kit for KWSET	52086956	
Spare Spring Kit for KWSET	52086957	
Spare Die Kit for KWSET	52086955	

Keyway punch

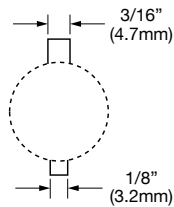

- ▶ Time-saving punching of slots for anti-twist protected parts
- ▶ Long service life

Suitable for

- Mild steel (St37) to 3 mm thick
- Manual operation

Item	Part No.	
Keyway punch	50265342	
Accessories	Part No.	Page
Spare punch for keyway punch	50265369	
Spare die for keyway punch	50265385	

Hydraulic punch Quick Draw 90™ 7904E



- ▶ Ideal for fast, straight-on front panel punching
- ▶ Head rotates 180° for maximum flexibility
- ▶ Very robust

Characteristics

- Compact design
- Hand hydraulic punch driver with 90° head

Suitable for

- Special shape punches up to a maximum size of 68 x 68 mm or 35 x 65 mm
- Round punches up to ISO 63 (64 mm dia.)

Additional information

- Accompanying draw studs to 64 mm ST37 are suitable

Technical data		
Dimension	312 x 110 x 65 mm	
Punching force	80 kN	
Weight	3.4 kg	
Item	Part No.	
Quick Draw 90™ 7904E	50342991	
Scope of supply	Part No.	Page
Hand hydraulic punch 7904E	50337866	
Draw stud for punch with hydraulic operation 9.5 x 71 mm	51300430	
Draw stud for hydraulic operation 19.0 x 105 mm	52085691	420
Spacer, short	50032488	
Adapter 19.0 x 48 mm with internal thread 9.5 mm	50339672	426
Plastic case	50352024	

Hydraulic punch driver Quick Draw™ 7804E



- ▶ Ideal for fast, straight-on front panel punching
- ▶ Compact design
- ▶ Very robust

Characteristics

- Hand hydraulic punch driver with straight head

Suitable for

- Special shape punches up to a maximum size of 68 x 68 mm or 35 x 65 mm
- Round punches up to ISO 63 (64 mm dia.)

Additional information

- Accompanying draw studs to 64 mm ST37 are suitable

Technical data		
Dimension	321 x 110 x 70 mm	
Punching force	80 kN	
Weight	2.5 kg	
Item	Part No.	
Quick Draw™ 7804E	50342916	
Scope of supply	Part No.	Page
Hand hydraulic punch 7804E	50342886	
Draw stud for punch with hydraulic operation 9.5 x 71 mm	51300430	
Draw stud for hydraulic operation 19.0 x 105 mm	52085691	420
Spacer, short	50032488	
Adapter 19.0 x 48 mm with internal thread 9.5 mm	50339672	420
Plastic case	50352024	



Manual hydraulic punch



► Flexible head for multi-purpose use even in confined areas

Characteristics

- Rotatable/Swivel

Suitable for

- Special shape punches up to a maximum size of 68 x 68 mm or 35 x 65 mm
- Round punches up to ISO 63 (64 mm dia.)

Additional information

- Hand-operated hydraulic punch incl. draw stud, pilot drill and spacer in plastic case
- Without hole
- Accompanying draw studs to 64 mm ST37 are suitable

Technical data

Dimension 340 x 150 x 85 mm

Punching force 80 kN

Weight 2.2 kg

Revolving/rotatable 360°

Item	Part No.	
Manual hydraulic punch	52033843	
Scope of supply	Part No.	Page
Draw stud for hydraulic operation 9.5 mm to 19 mm, 122 mm	52042827	
HSS Co5 step bit	52049371	459
Spacer, short	50032488	
Plastic case		

LS 50 FLEX battery powered hydraulic punching tool

**NEXT
GENERATION**



- ▶ High flexibility using 360° rotating head
- ▶ An integrated pressure sensor increases the service life of the hole punch
- ▶ Automatic stop makes the punching tools last longer

Characteristics

- Choose your battery system: Bosch or Makita
- All data can be easily read via Bluetooth
- Balanced centre of gravity for easy handling and effortless operations
- LED for work area illumination
- Energy saving function with motor cut-out after successful operation
- Manual retract as required
- Always ready-to-use thanks to battery charge and service display

Technical data			
Punching force	60 kN		
Weight	2.1 kg		
Charging time	15 min.		
Punching time	5 s at 22.5 mm dia., 3 mm mild steel 6 s at 63.5 mm dia., 3 mm mild steel		
Ambient temperature	-15 °C up to +40 °C		
Dimensions	340 x 115 x 80 mm		
Punching capacity	120 punch operations at 22.5 mm dia., 3.4 mm mild steel 190 punch operations at 22.5 mm dia., 3 mm mild steel 280 punch operations at 22.5 mm dia., 2.5 mm mild steel		
Item	Part No. Bosch	Part No. Makita	
LS 50 FLEX battery powered hydraulic punching tool	LS50FLEXCFB	LS50FLEXCFM	
Lieferumfang			Page
Bosch battery 18 V / 2.0 Ah, Li-Ion	RALB1EU		484
Bosch quick-charger for 18 V Li-Ion battery	LGLB1EU		486
Makita battery 18 V / 1.5 Ah, Li-Ion		RAL1	483
Makita quick-charger for 18 V Li-Ion battery		LGL1	486
Draw stud for hydraulic operation 19.0 x 105 mm	52085691	52085691	420
Spacer 22 mm, short	50032488	50032488	
HSS Co5 step bit	52049371	52049371	459
Adapter 19.0 x 48 mm with internal thread 9.5 mm	50339672	50339672	420
Draw stud for punch with hydraulic operation 9.5 x 71 mm	51300430	51300430	420
Plastic case	KK50FLEXNG	KK50FLEXNG	
Accessories			Page
Bosch battery 18 V / 5.0 Ah, Li-Ion	RALB2EU		485
Makita battery 18 V / 3.0 Ah, Li-Ion (54 Wh)		RAL2	483
Variants			Page
L-BOXX with flexible battery powered hydraulic punch LS50FLEXCFB	LBOXXLS50FLEXCFB		203
L-BOXX with flexible battery powered hydraulic punch LS50FLEXCFM		LBOXXLS50FLEXCFM	203



LS 100 FLEX battery powered hydraulic punching tool

**NEXT
GENERATION**



- ▶ High flexibility using rotating head
- ▶ An integrated pressure sensor increases the service life of the hole punch
- ▶ Automatic stop makes the punching tools last longer

Characteristics

- Choose your battery system: Bosch or Makita
- All data can be easily read via Bluetooth
- Balanced centre of gravity for easy handling and effortless operations
- LED for work area illumination
- Energy saving function with motor cut-out after successful operation
- Changeable modes for automatic or manual retraction
- Always ready-to-use thanks to battery charge and service display

Additional information

- When used with Speed Punch use the following draw studs: 52066000 (to ISO 25), 50032488, 52058897 (from ISO 25)



Technical data	
Punching force	100 kN
Weight	2.7 kg
Charging time	15 min.
Punching time	5 s at 22,5 mm dia., 3 mm mild steel 6 s at 63,5 mm dia., 3 mm mild steel
Ambient temperature	-15° up to +40 °C
Dimensions	370 x 120 x 80 mm
Punching capacity	St37 max.: 152.4 mm at a material thickness of 3 mm V2A max.: 104.8 mm at a material thickness of 3 mm

Item	Part No. Bosch	Part No. Makita	
LS 100 FLEX battery powered hydraulic punching tool	LS100FLEXCFB	LS100FLEXCFM	
Scope of supply			Page
Bosch battery 18 V / 5.0 Ah, Li-Ion	RALB2EU		458
Bosch quick-charger for 18 V Li-Ion battery	LGLB1EU		486
Makita battery 18 V / 4.0 Ah, Li-Ion		RAL40	484
Makita quick-charger for 18 V Li-Ion battery		LGL1	486
Draw stud for hydraulic operation 19.0 x 137 mm	52085692	52085692	420
Draw stud for hydraulic operation 9.5 mm to 19 mm, 122 mm	52042827	52042827	420
Spacer, short	50032488	50032488	
HSS Co5 step bit	52049371	52049371	459
Plastic case	KK50FLEXNG	KK50FLEXNG	

Hydraulic punch with hand pump



► Compact design

Characteristics

- With hand pump, hose and cylinder

Suitable for

- All punches up to 144.1 mm round and 138 x 138 mm square
- St37 up to 3.5 mm and 3.5 mm V2A (depending on punch size)

Operation

- Hydraulic

Additional information

- When used with Speed Punch use the following draw studs: 52066000 (to ISO 25), 50032488, 52058897 (from ISO 25)
- Draw stud 52085689 11.1 mm to 19mm, used for 22.5mm Pg16 SB-Punch*52085633, or 22.5mm Pg16 SR-Punch* 52085634.
*Suitable for mild steel 2.5mm / stainless steel 2mm

Technical data		
Punching force	110 kN	
Weight	8.3 kg	
Item	Part No.	
Hydraulic punch with hand pump	52084920	
Scope of supply	Part No.	Page
Hydraulic cylinder	50170910	
767 Hydraulic hand pump	50132849	482
Hydraulic hose 6.4 mm dia. x 0.9 m	50383167	
Draw stud for hydraulic operation 19.0 x 137 mm	52085692	
Draw stud for hydraulic operation 11.1 mm to 19 mm, 127 mm	52085689	

Hydraulic punch with foot pump



Characteristics

- With foot pump, hose and cylinder

Suitable for

- Up to 144.1 mm round and 138 x 138 mm square
- St37 up to 3.5 mm and 3.5 mm V2A (depending on punch size)

Operation

- Hydraulic

Additional information

- When used with Speed Punch use the following draw studs: 52066000 (to ISO 25), 50032488, 52058897 (from ISO 25)
- Draw stud 52085689 11.1 mm to 19mm, used for 22.5mm Pg16 SB-Punch*52085633, or 22.5mm Pg16 SR-Punch* 52085634.
*Suitable for mild steel 2.5mm / stainless steel 2mm

Technical data		
Punching force	110 kN	
Weight	15.2 kg	
Item	Part No.	
Hydraulic punch with foot pump	52084941	
Scope of supply	Part No.	Page
Hydraulic cylinder	50170910	
1725 Hydraulic foot pump	50313533	482
Hydraulic hose 6.4 mm dia. x 3 m	50377299	
Draw stud for hydraulic operation 19.0 x 137 mm	52085692	
Draw stud for hydraulic operation 11.1 mm to 19 mm, 127 mm	52085689	



Thread grease



- ▶ Increases the service life
- ▶ Prevents "seizing"
- ▶ Screw and nut threads resistant to wear

Suitable for

- Statically and dynamically high stressed thread connections

Item	Part No.
Draw stud thread grease, 30 g	50115472

Slug Buster® punch set for all applications from ISO 16 - 40



Suitable for

- Mild steel (St37), plastic and aluminium up to 3.5 mm

Operation

- Manual

Predrilling

- Draw stud 9.5 mm dia., pilot drill 9.7 mm dia. 50360183
draw stud 19.0 mm dia., pilot drill 20.5 mm dia. 50344030

Item	Part No.	
Slug Buster® punch set ISO 16 to 40	50366920	
Scope of supply	Part No.	Page
Slug Buster® punch set ISO 16/20/25/32/40	50356178SET	455
Draw studs for manual operation 9.5 x 40 mm	50000420	419
Draw studs for manual operation 19.0 x 55 mm	50040405	419
Ratchet	50349414	
Kwik Stepper™ step bit 9.7 mm	50360183	458
Plastic case	50366858	

Slug Buster® punch set for all applications from PG 9 to PG 21 and 30.5 mm



Suitable for

- Mild steel (St37), plastic and aluminium up to 3.5 mm

Operation

- Manual

Predrilling

- Draw stud 9.5 mm dia., pilot drill 9.7 mm dia. 50360183
draw stud 19.0 mm dia., pilot drill 20.5 mm dia. 50344030

Item	Part No.	
Slug Buster® punch set PG 9 to PG 21 and 30.5 mm	50366904	
Scope of supply	Part No.	Page
Slug Buster® punch set PG 9 - 21, 30.5 mm	50323989SET	446
Draw studs for manual operation 9.5 x 40 mm	50000420	419
Ratchet	50349414	
Kwik Stepper™ step bit 9.7 mm	50360183	458
Plastic case	50366858	

Slug Buster® punch set for ISO 16 - 63



Suitable for

- Mild steel (St37), plastic and aluminium up to 3.5 mm

Operation

- Manual

Predrilling

- Draw stud 9.5 mm dia., pilot drill 9.7 mm dia. 50360183
draw stud 19.0 mm dia., pilot drill 20.5 mm dia. 50344030

Item	Part No.	
Slug Buster® punch set ISO 16 to 63	50366939	
Scope of supply	Part No.	Page
Slug Buster® punch set ISO 16 - 63	50068920SET	445
Draw studs for manual operation 9.5 x 40 mm	50000420	419
Draw studs for manual operation 19.0 mm x 75 mm	50040421	
Ratchet	50349414	
Kwik Stepper™ step bit 9.7 mm	50360183	458
Plastic case	50366858	



Slug Buster® punch set for all applications from PG 9 - 48 and 30.5 mm



Suitable for

- Mild steel (St37), plastic and aluminium up to 3.5 mm

Operation

- Manual

Predrilling

- Draw stud 9.5 mm dia., pilot drill 9.7 mm dia. 50360183
draw stud 19.0 mm dia., pilot drill 20.5 mm dia. 50344030

Item	Part No.	
Slug Buster® punch set PG 9 to PG 48 and 30.5 mm	50366912	
Scope of supply	Part No.	Page
Draw studs for manual operation 9.5 x 40 mm	50000420	419
Draw studs for manual operation 19.0 x 55 mm	50040405	419
Ratchet	50349414	
Slug Buster® punch set PG 9 - 48, 30.5 mm	50328034SET	446
Plastic case	50366858	

Speed Punch™ Set ISO 16 – 40



- ▶ Up to 3-times faster than conventional punching tools
- ▶ Easy and quick handling as the screwing and unscrewing of the counter nut is not required
- ▶ Compatible with all Greenlee hand-operated and battery powered hydraulic tools
- ▶ No greasing of the draw stud required

Suitable for

- Mild steel (St37), plastic and aluminium up to 3.5 mm
- LS50Flex and Quick Draw

Operation

- Hydraulic

Predrilling

- Draw stud 9.5 mm dia., pilot drill 9.7 mm dia. 50360183
draw stud 19.0 mm dia., pilot drill 20.5 mm dia. 50344030

Scope of supply

- Complete system including draw stud, cramp, punch and die incl. plastic case

Item	Part No.	
Speed Punch™ punch set ISO 16/20/25/32/40	52055439SET	
Scope of supply	Part No.	Page
Punch and die ISO 16 (16.2 mm)	52055431	418
Punch and die ISO 20 (20.4 mm)	52055432	418
Punch and die ISO 25 (25.4 mm)	52055434	418
Punch and die ISO 32 (32.5 mm)	52055435	418
Punch and die ISO 40 (40.5 mm)	52055436	418
Speed Lock and draw stud 9.5 mm for ISO 16/20/25 and PG 16	52055439	418
Speed Lock and draw stud 19.0 mm for ISO 32/40/50/63	52055440	418
Plastic case	KKSPISO16B63	
Accessories	Part No.	Page
Plastic case	KKSPISO16B63	

Speed Punch™ Set ISO 16 – 63



- ▶ Up to 3-times faster than conventional punching tools
- ▶ Easy and quick handling as the screwing and unscrewing of the counter nut is not required
- ▶ Compatible with all Greenlee hand-operated and battery powered hydraulic tools
- ▶ No greasing of the draw stud required

Suitable for

- Mild steel (St37), plastic and aluminium up to 3.5 mm
- LS50Flex and Quick Draw

Operation

- Hydraulic

Predrilling

- Draw stud 9.5 mm dia., pilot drill 9.7 mm dia. 50360183
draw stud 19.0 mm dia., pilot drill 20.5 mm dia. 50344030

Scope of supply

- Complete system including draw stud, cramp, punch and die incl. plastic case

Item	Part No.	
Speed Punch™ Set ISO 16 – 63	52055440SET	
Scope of supply	Part No.	Page
Punch and die ISO 16 (16.2 mm)	52055431	418
Punch and die ISO 20 (20.4 mm)	52055432	418
Punch and die ISO 25 (25.4 mm)	52055434	418
Punch and die ISO 32 (32.5 mm)	52055435	418
Punch and die ISO 40 (40.5 mm)	52055436	418
Punch and die ISO 50 (50.8 mm)	52055437	418
Punch and die ISO 63 (64.0 mm)	52055438	418
Speed Lock and draw stud 9.5 mm for ISO 16/20/25 and PG 16	52055439	418
Speed Lock and draw stud 19.0 mm for ISO 32/40/50/63	52055440	418
Plastic case	KKSPISO16B63	
Accessories	Part No.	Page
Plastic case	KKSPISO16B63	

Slug-Splitter® punch set (stainless steel) ISO 16 - 40



- ▶ Unique punch profile
- ▶ Split slugs fall free and can be removed easily

Suitable for

- Stainless steel (V2A), mild steel (St37), plastic and aluminium up to 3.5 mm thick

Operation

- Hydraulic

Predrilling

- Draw stud 19 mm dia., pilot drill 20.5 mm dia. 50344030
draw stud 11.1 mm dia., pilot drill 12.7 mm dia. 50344102

Item	Part No.	
Slug-Splitter® punch set (stainless steel) ISO 16/20/25/32/40	50766803	
Scope of supply	Part No.	Page
Slug-Splitter® punch (stainless steel) 16.2 mm	50069527	417
Slug-Splitter® punch (stainless steel) 20.4 mm	50069543	417
Slug-Splitter® punch (stainless steel) 25.4 mm	50069560	417
Slug-Splitter® punch (stainless steel) 32.5 mm	50069594	417
Slug-Splitter® punch (stainless steel) 40.5 mm	50069616	417
Draw stud for hydraulic operation 11.1 mm to 19 mm, 108 mm	50294512	420
Draw stud for hydraulic operation 19 x 140 mm	50294520	420
Plastic case	KKSSISO16B63	

Slug-Splitter® punch set (stainless steel) ISO 16 - 63



- ▶ Unique punch profile
- ▶ Split slugs fall free and can be removed easily

Suitable for

- Stainless steel (V2A), mild steel (St37), plastic and aluminium up to 3.5 mm thick

Operation

- Hydraulic

Predrilling

- Draw stud 19 mm dia., pilot drill 20.5 mm dia. 50344030
draw stud 11.1 mm dia., pilot drill 12.7 mm dia. 50344102

Item	Part No.	
Slug-Splitter® punch set (stainless steel) ISO 16/20/25/32/40/50/63	50766797	
Scope of supply	Part No.	Page
Slug-Splitter® punch (stainless steel) 16.2 mm	50069527	417
Slug-Splitter® punch (stainless steel) 20.4 mm	50069543	417
Slug-Splitter® punch (stainless steel) 25.4 mm	50069560	417
Slug-Splitter® punch (stainless steel) 32.5 mm	50069594	417
Slug-Splitter® punch (stainless steel) 40.5 mm	50069616	417
Slug-Splitter® punch (stainless steel) 50.8 mm	50069632	417
Slug-Splitter® punch (stainless steel) 64 mm	50069667	417
Draw stud for hydraulic operation 11.1 mm to 19 mm, 108 mm	50294512	420
Draw stud for hydraulic operation 19 x 140 mm	50294520	420
Plastic case	KKSSISO16B63	

Slug Buster® hand hydraulic punch driver set PG 9 - PG 21, 30.5 mm



Suitable for

- Mild steel (St37), plastic and aluminium up to 3.5 mm

Operation

- Hydraulic

Predrilling

- Draw stud 9.5 mm dia., pilot drill 9.7 mm dia. 50360183
draw stud 19.0 mm dia., pilot drill 20.5 mm dia. 50344030

Item	Part No.	
Slug Buster® hand hydraulic punch driver set PG 9 to PG 21 and 30.5 mm	50356119SET	
Scope of supply	Part No.	Page
Hand hydraulic punch 7804E	50342886	
Draw stud for punch with hydraulic operation 9.5 x 71 mm	51300430	420
Draw stud for hydraulic operation 19.0 x 105 mm	50318721	420
Spacer, short	50032488	
Adapter 19.0 x 48 mm with internal thread 9,5 mm	50339672	420
Slug Buster® punch set PG 9 - 21, 30.5 mm	50323989SET	446
Plastic case	50352024	

Slug Buster® hand hydraulic 90° punch driver set PG 9 - PG 21, 30.5 mm



Suitable for

- Mild steel (St37), plastic and aluminium up to 3.5 mm thick

Operation

- Hydraulic

Predrilling

- Draw stud 9.5 mm dia., pilot drill 9.7 mm dia. 50360183
draw stud 19.0 mm dia., pilot drill 20.5 mm dia. 50344030

Item	Part No.	
Slug Buster® hand hydraulic punch driver set PG 9 to PG 21 and 30.5 mm	50356151SET	
Scope of supply	Part No.	Page
Hand hydraulic punch 7904E	50337866	
Draw stud for punch with hydraulic operation 9.5 x 71 mm	51300430	420
Draw stud for hydraulic operation 19.0 x 105 mm	50318721	420
Spacer, short	50032488	
Adapter 19.0 x 48 mm with internal thread 9,5 mm	50339672	420
Slug Buster® punch set PG 9 - 21, 30.5 mm	50323989SET	446
Plastic case	50352024	



Slug Buster® hand hydraulic punch driver set ISO 16 - 40



Suitable for

- Mild steel (St37), plastic and aluminium up to 3.5 mm thick

Operation

- Hydraulic

Predrilling

- Draw stud 9.5 mm dia., pilot drill 9.7 mm dia. 50360183
draw stud 19.0 mm dia., pilot drill 20.5 mm dia. 50344030

Item	Part No.	
Slug Buster® hand hydraulic punch driver set ISO 16 to 40	50356143SET	
Scope of supply	Part No.	Page
Hand hydraulic punch 7804E	50342886	
Draw stud for punch with hydraulic operation 9.5 x 71 mm	51300430	420
Draw stud for hydraulic operation 19.0 x 105 mm	50318721	420
Spacer, short	50032488	
Adapter 19.0 x 48 mm with internal thread 9,5 mm	50339672	420
Slug Buster® punch set ISO 16/20/25/32/40	50356178SET	445
Plastic case	50352024	

Slug Buster® hand hydraulic 90° punch driver set ISO 16 - 40



Suitable for

- Mild steel (St37), plastic and aluminium up to 3.5 mm thick

Operation

- Hydraulic

Predrilling

- Draw stud 9.5 mm dia., pilot drill 9.7 mm dia. 50360183
draw stud 19.0 mm dia., pilot drill 20.5 mm dia. 50344030

Item	Part No.	
Slug Buster® hand hydraulic punch driver set ISO 16 to 40	50356160SET	
Scope of supply	Part No.	Page
Hand hydraulic punch 7904E	50337866	
Draw stud for punch with hydraulic operation 9.5 x 71 mm	51300430	420
Draw stud for hydraulic operation 19.0 x 105 mm	50318721	420
Spacer, short	50032488	
Adapter 19.0 x 48 mm with internal thread 9,5 mm	50339672	420
Slug Buster® punch set ISO 16/20/25/32/40	50356178SET	445
Plastic case	50352024	

Hand hydraulic punching set 90° ISO 16 - 40



- ▶ Flexible head for multi-purpose use even in confined areas

Suitable for

- Special shape punches up to a maximum size of 68 x 68 mm or 35 x 65 mm
- Round punches up to ISO 63 (64 mm dia.)

Item	Part No.	
Hand hydraulic punching set ISO 16 - 40	52034233	
Scope of supply	Part No.	Page
Slug Buster® punch set ISO 16/20/25/32/40	50356178SET	445
Draw stud for hydraulic operation 9.5 mm to 19 mm, 122 mm	52042827	420
Draw stud for hydraulic operation 19.0 x 105 mm	50318721	420
Spacer, short	50032488	
HSS Co5 step bit	52049371	459
Plastic case	KK520342333	

Slug Buster® punch set ISO 16 – 40



- ▶ For quick, clean, effortless and burr-free holes
- ▶ Split slugs fall free and can be removed easily

Suitable for

- Mild steel (St37), plastic and aluminium to 3.0 mm

Operation

- Manual

Predrilling

- Draw stud 9.5 mm dia., pilot drill 9.7 mm dia. 50360183
draw stud 19.0 mm dia., pilot drill 20.5 mm dia. 50344030

Scope of supply

- Complete system including punch and die incl. plastic case

Item	Part No.	
Slug Buster® punch set ISO 16/20/25/32/40	50356178SET	
Accessories	Part No.	Page
Plastic case	KKISO16B63	

Slug Buster® punch set ISO 16 – 63



- ▶ Long product life
- ▶ Very easy to use

Suitable for

- Mild steel (St37), plastic and aluminium up to 3.5 mm

Operation

- Manual

Predrilling

- Draw stud 9.5 mm dia., pilot drill 9.7 mm dia. 50360183
draw stud 19.0 mm dia., pilot drill 20.5 mm dia. 50344030

Scope of supply

- Complete system including punch and die incl. plastic case

Item	Part No.	
Slug Buster® punch set ISO 16/20/25/32/40/50/63	50068920SET	
Accessories	Part No.	Page
Plastic case	KKISO16B63	



Slug Buster® punch set PG 9 - 21, 30.5 mm



- ▶ Unique punch profile
- ▶ Split slugs fall free and can be removed easily

Suitable for

- Mild steel (St37), plastic and aluminium up to 3.5 mm

Operation

- Manual

Predrilling

- Draw stud 9.5 mm dia., pilot drill 9.7 mm dia. 50360183
draw stud 19.0 mm dia., pilot drill 20.5 mm dia. 50344030

Scope of supply

- Complete system including punch and die incl. plastic case

Item	Part No.	
Slug Buster® punch set PG 9/11/13/16/21 and 30.5 mm	50323989SET	
Accessories	Part No.	Page
Plastic case	KKPG9B48	

Slug Buster® punch set PG 9 - PG 48, 30.5 mm



- ▶ Unique punch profile
- ▶ Split slugs fall free and can be removed easily

Suitable for

- Mild steel (St37), plastic and aluminium up to 3.5 mm

Operation

- Manual

Predrilling

- Draw stud 9.5 mm dia., pilot drill 9.7 mm dia. 50360183
draw stud 19.0 mm dia., pilot drill 20.5 mm dia. 50344030

Scope of supply

- Complete system including punch and die incl. plastic case

Item	Part No.	
Slug Buster® punch set PG 9/11/13/16/21/29/36/48 and 30.5 mm	50328034SET	
Accessories	Part No.	Page
Plastic case	KKPG9B48	

